

Apartment 105, The Vale

A beautiful one-bedroom apartment on the ground floor

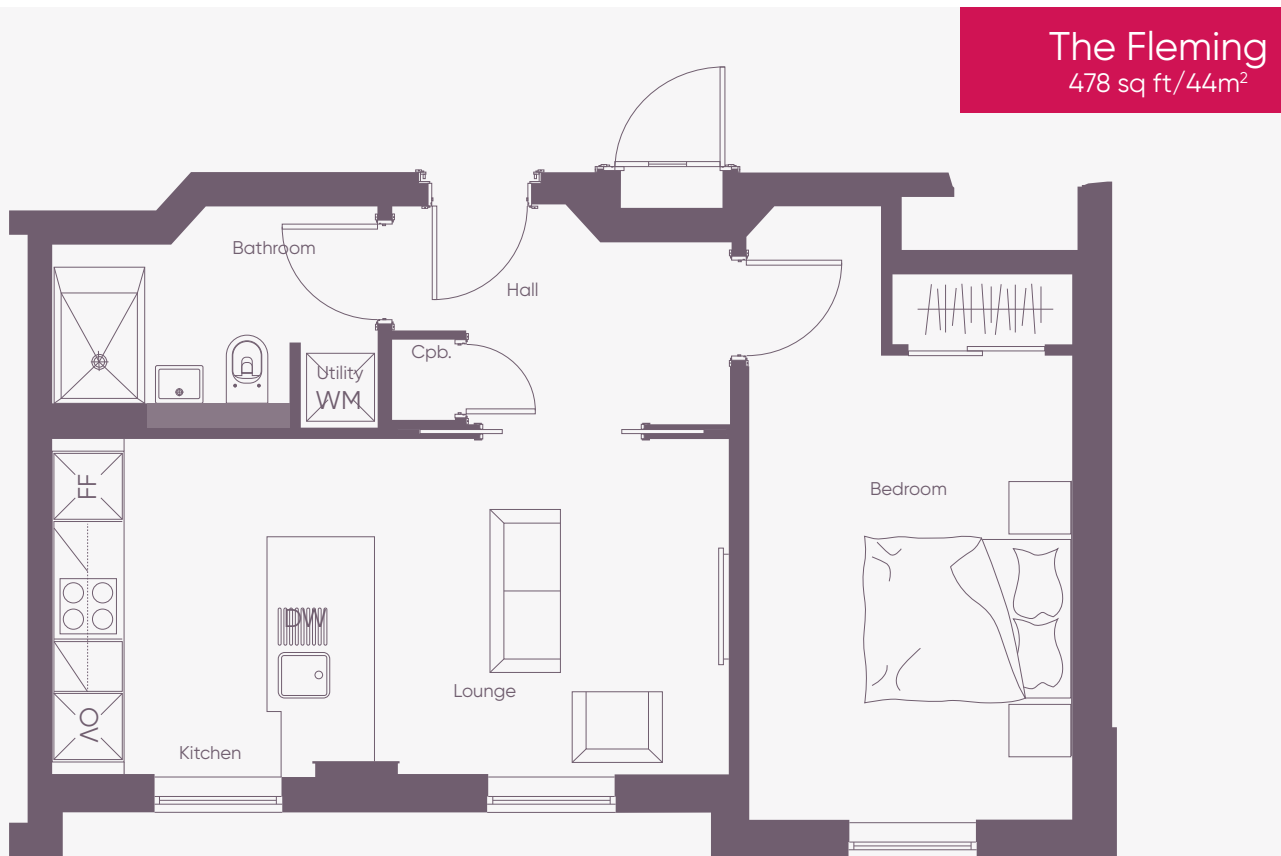

An open-plan living area makes The Fleming a stylish and comfortable home. It comprises a contemporary, fully-fitted kitchen - complete with high-specification and energy-efficient appliances - along with a spacious dining and living area. The double master bedroom features built-in wardrobes, while the bathroom is a haven of style and comfort.

Internal measurements

Kitchen & Lounge	19' 5" x 9' 7"	5,950 x 2,955mm
Bedroom	15' 7" x 9' 3"	4,805 x 2,850mm
Bathroom	9' 4" x 5' 9"	2,855 x 1,735mm
Hall	7' 6" x 5' 2"	2,330 x 1,600mm
Cupboard	2' 3" x 1' 8"	710 x 555mm

All layouts/dimensions are for illustrative purposes only. Maximum distances shown. Apartments rented unfurnished. Moveable furniture not included. Rooms shown may not be representative of this apartment.



All CGI imagery is illustrative. Apartments rented unfurnished. Moveable furniture not included. Rooms shown may not be representative of this apartment.